

**FOR MORE INFO call the REX-TEAM**

Barbara Compton (239-285-3600)  
 or Roland Hauber (239-285-3700)

Bus: 239-394-2494 Fax: 239-389-0766

e-mail: [info@rexmi.com](mailto:info@rexmi.com)

*Provence of Marco*

*Garden Villas*

*First Floor Units*

*Units D-1, D-2, E-1, E-2, F-1, F-2, G-1, G-2*

*Air conditioned space = 1948*



All Dimensions are approximate and are subject to change without notice. All features, amenities, prices and availability are subject to change without notice. Information deemed to be reliable but can not be guaranteed. Oral representations cannot be relied upon as correctly stating representations of the developer. For correct representations make reference to brochure and to the documents required by section 718.503, Florida Statutes to be furnished by a developer to a buyer or lessee.

PH 1 and  
Terrace Suite A-301  
2376 Sq. Ft

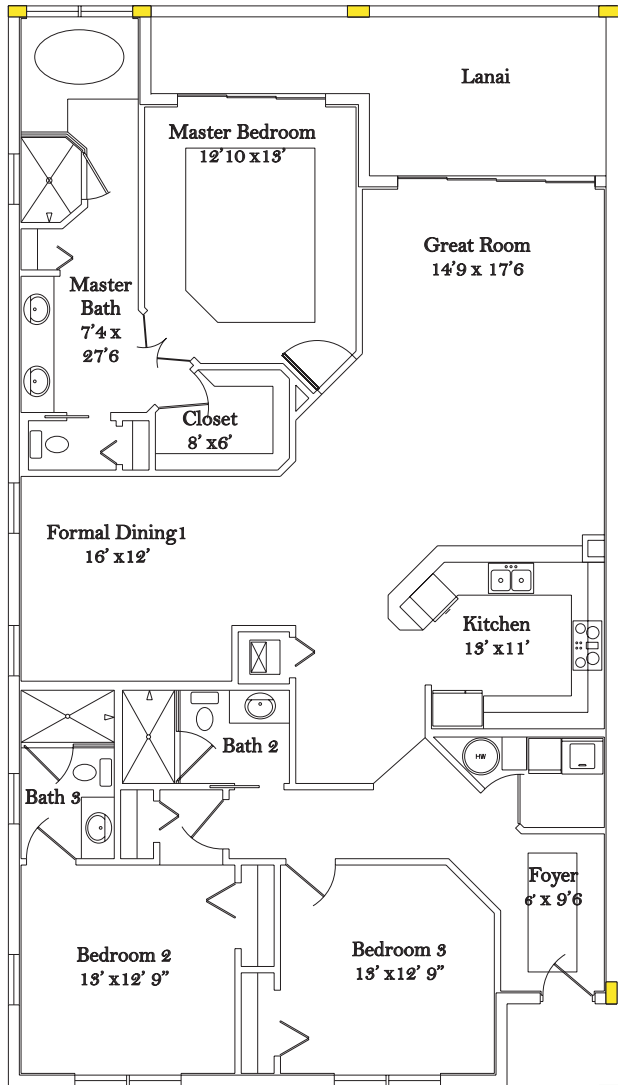

PH 2 and  
Terrace Suites A-302 to  
A-307 even #'s are mirrored  
2354 Sq. Ft

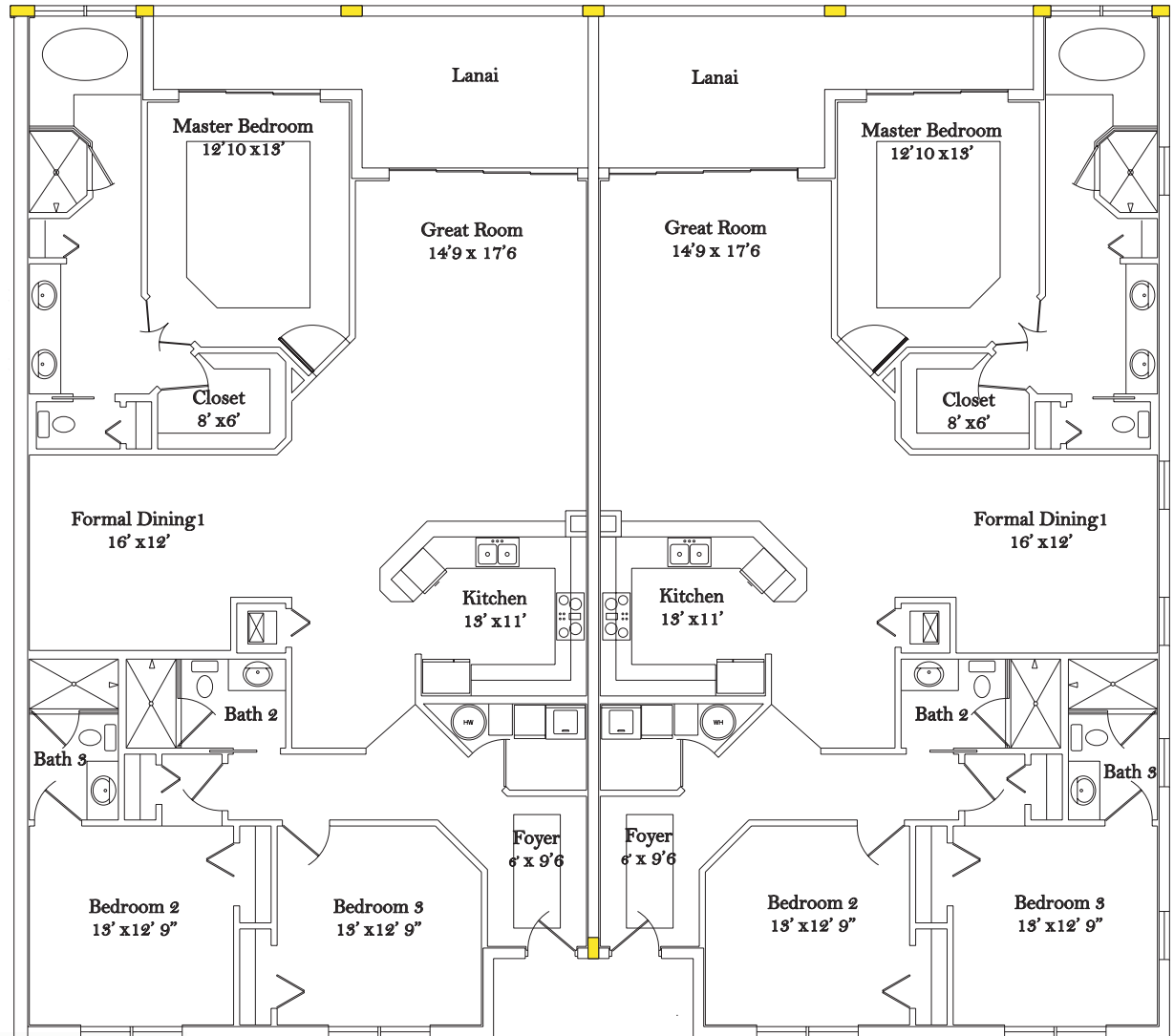

PH 8 and  
Terrace Suite A-308  
2376 Sq. Ft



**FOR MORE INFO call the REX-TEAM**

Barbara Compton (239-285-3600)  
or Roland Hauber (230-285-3700)

Bus: 239-394-2494 Fax: 239-389-0766

e-mail: [info@rexmi.com](mailto:info@rexmi.com)

All dimensions are approximate and are subject to change without notice. All features amenities, prices and availability are subject to change without notice. Information deemed to be reliable but can not be guaranteed. Oral representations cannot be relied upon as correctly stating representations of the developer. For correct representations make reference to brochure and to the documents required by section "718503" Florida Statutes to be furnished by developer to a buyer or lessee.



# PROVENCE OF MARCO

## Location

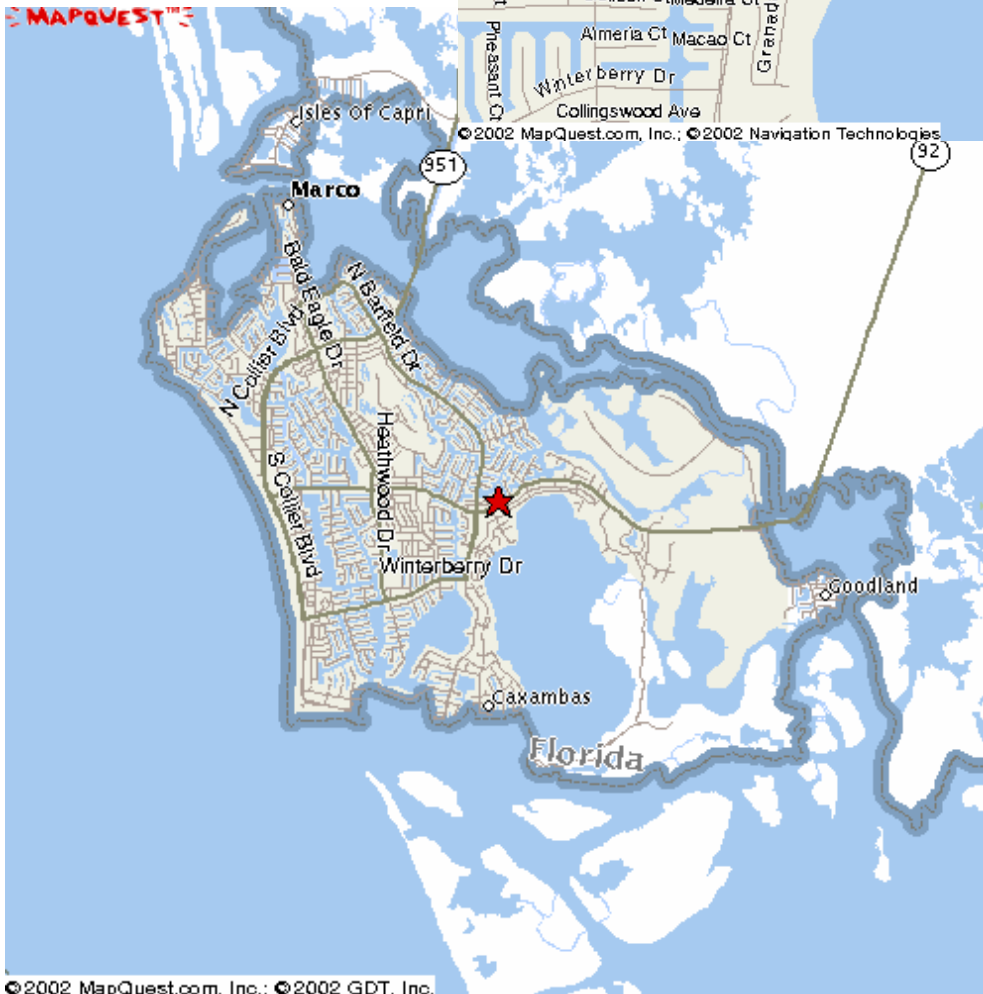
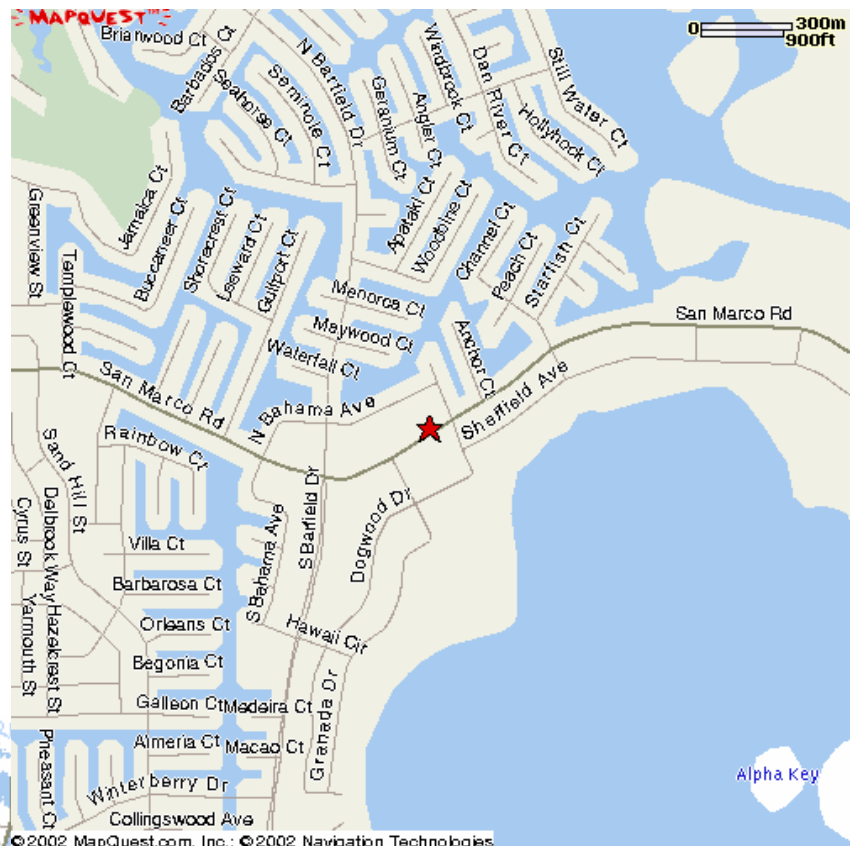



**THE REX TEAM**  
**PRESENTS...**  
**WWW.REXMI.COM**

***PROVENCE OF MARCO***

***FEATURES:***

32 BEAUTIFULLY APPOINTED RESIDENTIAL CONDOMINIUMS  
14 PROFESSIONAL OFFICE SUITES/RETAIL SHOPS

**GARDEN VILLAS**

FOUR SEPARATE VILLA BUILDINGS FEATURING  
FOUR BEAUTIFUL GARDEN RESIDENCES PER BUILDING

**PROVENCE TERRACE SUITES & PENTHOUSES**

EIGHT GORGEOUS RESIDENCES  
&  
EIGHT BEAUTIFUL PENTHOUSE SUITES!

THESE RESIDENCES ARE LOCATED ON THE THIRD AND FOURTH LEVELS!

COME EXPERIENCE THE WARMTH AND ELEGANCE OF

**THE PROVENCE OF MARCO**



ROLAND HAUBER & BARBARA COMPTON

Realty Executives Marco Island  
Roland Hauber & Barbara Compton  
149 South Barfield Drive  
Marco Island, FL 34145  
Phone: 239 394 2494 Fax: 239 389 0766  
E-mail: [info@rexmi.com](mailto:info@rexmi.com)  
WEB: [www.rexmi.com](http://www.rexmi.com)



## RESIDENTIAL APPOINTMENTS

### GARDEN VILLAS:

EACH VILLA CONSISTS OF FOUR RESIDENCES WITH TWO ON THE LOWER LEVEL AND TWO ON THE UPPER LEVEL.

LOWER LEVEL RESIDENCES ARE APPROXIMATELY 1948 SQUARE FEET. FEATURING 3 BEDROOMS, 2½ BATHROOMS WITH TEN-FOOT CEILINGS.

UPPER LEVEL RESIDENCES ARE APPROXIMATELY 2068 SQUARE FEET.

FEATURING THREE BEDROOMS AND 2 BATHROOMS WITH TEN-FOOT CEILINGS.

ALL VILLAS INCLUDE A SINGLE GARAGE

RESALE PRICING OFFERED AT \$535,000 TO \$595,000

### PROVENCE TERRACES

### SUITES & PENTHOUSES:

TERRACE SUITES WILL FEATURE EIGHT GORGEOUS CONDOMINIUMS WITH APPROXIMATELY 2354 TO 2376 SQUARE FEET, THREE BEDROOMS AND THREE BATHROOMS AND TEN-FOOT CEILINGS, COVERED PARKING

THIRD LEVEL SUITES RESALE PRICING OFFERED \$520,000-595,000

TERRACE PENTHOUSES WILL FEATURE EIGHT STUNNING PENTHOUSES!

EACH PENTHOUSE WILL BE APPROXIMATELY 2354 TO 2376 SQUARE FEET, THREE BEDROOMS, THREE BATHROOMS AND 10 FOOT CEILINGS

FOURTH LEVEL PENTHOUSE PRICING  
\$595,000. INCLUDING DOUBLE CAR GARAGE

OTHER AMENITIES INCLUDE PRIVATE CLUBHOUSE & POOL



ROLAND HAUBER & BARBARA COMPTON

Realty Executives Marco Island  
149 South Barfield Drive  
Marco Island, FL 34145  
Phone: 239 394 2494 Fax: 239 394 4899  
E-mail: [rexmi.com](mailto:rexmi.com)  
WEB: [www.rexmi.com](http://www.rexmi.com)



**PROFESSIONAL OFFICE /RETAIL SUITES:**

TEN STANDARD OFFICE SUITES RANGING FROM 890 SQ. FT TO 924 SQ. FT.

ONE DESIRABLE LOBBY SUITE FEATURING 4 PRIVATE OFFICES,  
2 CONFERENCE ROOMS AND LOBBY AREA TOTAL 3400 SQ. FT.

*RESALE AVAILABLE*

REALTY EXECUTIVES MARCO ISLAND  
149 SOUTH BARFIELD DRIVE @ SHOPS OF MARCO  
MARCO ISLAND, FL 34145  
PHONE: 239 394 2494 FAX: 239 394 4899  
E-MAIL: [INFO@REXMI.COM](mailto:INFO@REXMI.COM)  
WEB: [WWW.REXMI.COM](http://WWW.REXMI.COM)

FOR FURTHER INFORMATION ON THE PROVENCE OF MARCO!

PLEASE CONTACT REALTY EXECUTIVES OF MARCO ISLAND

TO DOWNLOAD FLOORPLANS, PRICE LIST, RESERVATION AGREEMENTS,  
PLEASE CLICK ON LINK BELOW.

[HTTP://WWW.REXMI.COM/LISTINGS/PROVENCE/PROVENCE.PDF](http://WWW.REXMI.COM/LISTINGS/PROVENCE/PROVENCE.PDF)



ROLAND HAUBER & BARBARA COMPTON

Realty Executives Marco Island  
149 South Barfield Drive  
Marco Island, FL 34145  
Phone: 239 394 2494 Fax: 239 394 4899  
E-mail: [rexmi.com](mailto:rexmi.com)  
WEB: [www.rexmi.com](http://www.rexmi.com)



PROVENCE VILLAS  
4 Units per building 1950sf and up ,  
access to units through garage also  
possible



PROVENCE MAIN BUILDING 16 RESIDENTIAL  
UNITS and 14 OFFICES ON 1st floor

